



NEW
FOR
2010!

PRO Bell'O CHIC EUROPEAN DEEP BROWN FINISH WOOD A/V CABINET

*T*his chic audio/video cabinet will elegantly display most televisions up to 65" or 175 lbs. Finely crafted of hardwood solids covered with a hand rubbed Deep European Brown veneer finish, and a thick tempered safety glass top that appears to float above the cabinet. The dark tinted tempered safety glass doors with adjustable interior shelves will hide up to 6 or more audio/video components while allowing remote control operation. The fabric covered center section will hide a center channel speaker and offers storage or room for additional components. Rear panels are removable for simple installation and component access. An integrated CMS® Cable Management System contains interior and rear slots to hide and route wires and interconnect cables, and to provide proper air circulation. Ships assembled.

DETAILED DIMENSIONS

Overall: 65" w x 24" h x 22" d

Usable Center Channel Shelf:
20³/₈" w x 6¹/₄" h x 16⁷/₈" d

Usable Center Middle Shelf:
20³/₈" w x 5¹/₂" h* x 16⁷/₈" d

Usable Center Bottom Shelf:
20³/₈" w x 5¹/₂" h x 17⁷/₈" d

Usable Side Top Shelves:
20¹/₈" w x 9³/₈" h* x 19³/₄" d

Usable Side Bottom Shelves:
20¹/₈" w x 9³/₈" h x 19³/₄" d

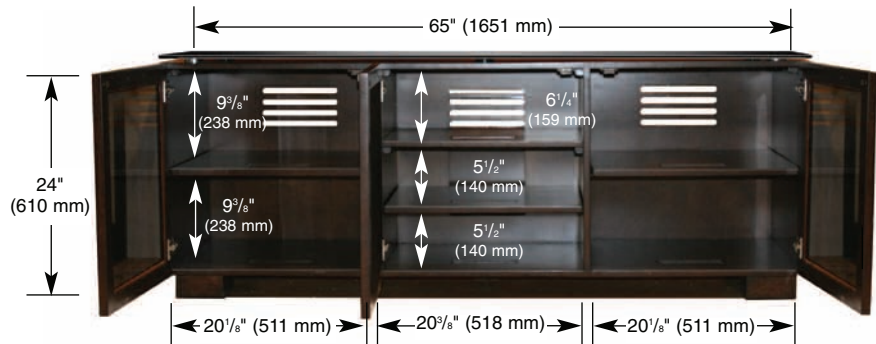

**Shelves are 3-Position Adjustable
Up or Down in 1" Increments, Height
Measurements are in Center Position*

Weight Capacities:

Top Shelf: 175 lbs. (79.4 kg)

Lower Shelves: 50 lbs. (22.7 kg)

All measurements shown are nominal usable space.
Specifications are subject to change without notice.



DESIGN FEATURES



- Accommodates most Flat Panel TVs up to 65", plus at least 6 audio/video components
- Chic design features finely crafted hardwood solids covered with a hand rubbed Deep European Brown veneer finish
- Fabric covered center section hides a center channel speaker and offers storage for additional components
- Rear panels are removable for simple installation and component access
- Integrated CMS® Cable Management System contains interior and rear slots to hide and route wires and interconnect cables

©2010 Bell'O International Corporation. All designs are patented or patent pending. Pricing, availability and specifications are subject to change without notice.